

CUCKFIELD RURAL DISTRICT COUNCIL

TOWN AND COUNTRY PLANNING GENERAL DEVELOPMENT ORDER 1973

WHEREAS the Cuckfield Rural District Council as agents for the West Sussex County Council, the local planning authority, are satisfied that it is expedient that development of Classes II.1, IV.2, VI.1, ^{VII}IX and XXII specified in Schedule 1 of the Town and Country Planning General Development Order 1973 (in this direction referred to as "the said development") should not be carried out within the area of land south-east of Newlands Hammingden Lane in the Parish of West Hoathly which area of land is shown edged red on the plan attached hereto unless permission therefor is granted on an application duly made in that behalf

NOW THEREFORE the Rural District Council in exercise of the powers conferred upon them by Article 4 of the Town and Country Planning General Development Order 1973 HEREBY DIRECT that the permission granted by Article 3 of the said Order shall not apply in the area shown edged red on the said plan to the said development

This Direction may be cited as the Cuckfield Rural District (Newlands, Hammingden Lane, West Hoathly) Direction 1973

THE COMMON SEAL of the RURAL DISTRICT COUNCIL OF CUCKFIELD was hereunto affixed on the 20th day of September 1973 in the presence of:

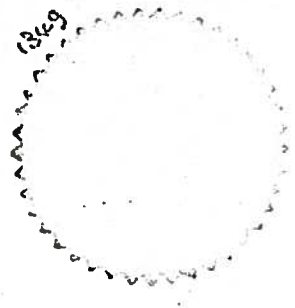

M. H. Hales
Chairman

DOE 13204

[Signature]
Clerk

The Secretary of State for the Environment hereby approves the foregoing direction.

Signed by authority of the Secretary of State
21st November 1973

An Assistant Secretary in the Department of the Environment.

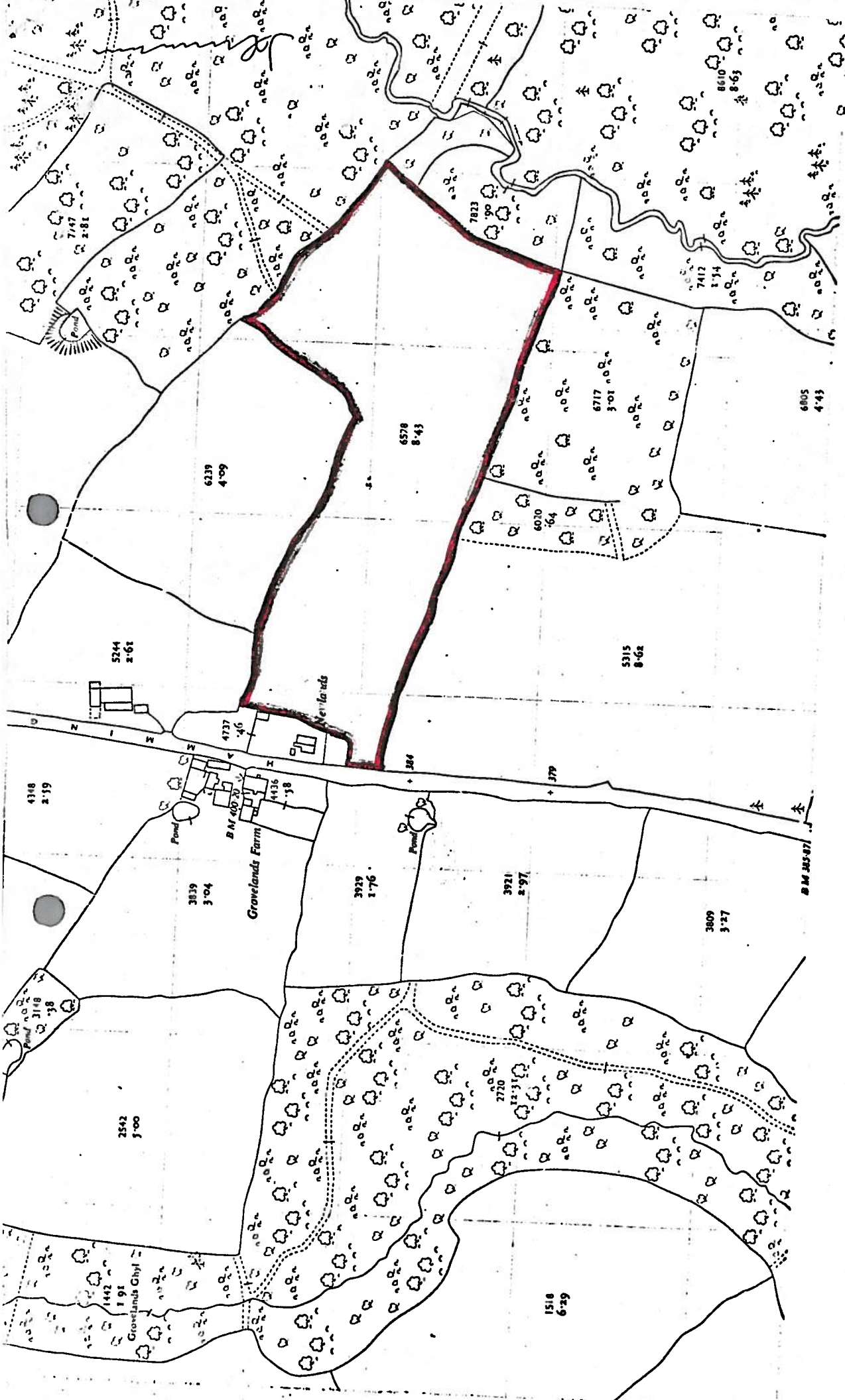

CUCKFIELD RURAL DISTRICT COUNCIL

TOWN AND COUNTRY PLANNING GENERAL DEVELOPMENT ORDER 1973

WHEREAS the Cuckfield Rural District Council as agents for the East Sussex County Council the local planning authority are satisfied that it is expedient that development of Classes 11.1, 1V.2, VI.1, ^{VII} 1X and XXII specified in Schedule 1 of the Town and Country Planning General Development Order 1973 (in this direction referred to as "the said development") should not be carried out within the area of land south-east of Newlands Hammingden Lane in the Parish of West Hoathly which area of land is shown edged red on the plan attached hereto unless permission therefor is granted on an application duly made in that behalf

NOW THEREFORE the Rural District Council in exercise of the powers conferred upon them by Article 4 of the Town and Country Planning General Development Order 1973 HEREBY DIRECT that the permission granted by Article 3 of the said Order shall not apply in the area shown edged red on the said plan to the said development

This Direction may be cited as the Cuckfield Rural District (Newlands, Hammingden Lane, West Hoathly) Direction 1973

THE COMMON SEAL of the RURAL DISTRICT)
COUNCIL OF CUCKFIELD was hereunto)
affixed on the 25th day of September 1973)
in the presence of:

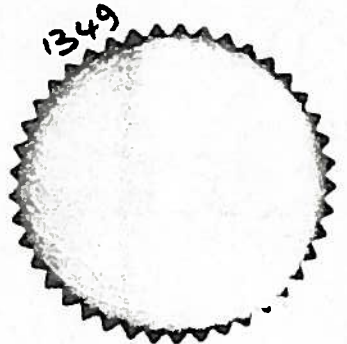

M. L. Hester Williams
Chairman

Blummin
Clerk