

Form	Application for a premises licence
service_team_name	Licensing Team
service_email_addresses	licensing@midsussex.gov.uk

Your Details

Name/s:	EURO GARAGES LIMITED
----------------	----------------------

Premises

Postal address of premises or, if none, ordnance survey map reference or description:	Asda Express PFS Copthorne, Copthorne Common Road, Copthorne, Crawley, Sussex
--	---

Postcode	RH10 3LF
-----------------	----------

Phone (at premises)	01342-714695
----------------------------	--------------

Email

Non-domestic rateable value of premises.	
---	--

Plan of premises	Attached
-------------------------	----------

Applicant type

Please state whether you are applying for a premises licence as:	a person other than an individual - i) as a limited company
---	---

Applicant type

Please confirm:	I am carrying on or proposing to carry on a business which involves the use of the premises for licensable activities
------------------------	---

Individual Applicants

Second Applicant

Other Applicants

Name	EURO GARAGES LIMITED
-------------	----------------------

Address	ASDA HOUSE, SOUTHBANK, GREAT WILSON STREET, LEEDS
----------------	---

Postcode	LS11 5AD
-----------------	----------

Registered number (where applicable)	04246195
---	----------

Description	COMPANY
--------------------	---------

Phone

Email

Operating Schedule

When do you want	15/06/2024
-------------------------	------------

the premises licence to start?

If you wish the licence to be valid only for a limited period, when do you want it to end?

If 5,000 or more people are expected to attend the premises at any one time, please state the number expected to attend.

Description of premises

Description CONVENIENCE STORE/PETROL FILLING STATION

Licensable Activities

Plays

Will you be provisioning Plays? No

Monday

Tuesday

Wednesday

Thursday

Friday

Saturday

Sunday

Films

Will you be provisioning Films? No

Monday

Tuesday

Wednesday

Thursday

Friday

Saturday

Sunday

Indoor Sports

Will you be provisioning Indoor Sporting events? No

Monday

Tuesday

Wednesday

Thursday

Friday

Saturday

Sunday

Boxing or wrestling

Will you be provisioning boxing or wrestling events? No

Monday

Tuesday

Wednesday

Thursday

Friday

Saturday

Sunday

Live Music

Will you be provisioning Live Music? No

Monday

Tuesday

Wednesday

Thursday

Friday

Saturday

Sunday

Recorded Music

Will you be provisioning Recorded Music? No

Monday

Tuesday

Wednesday

Thursday

Friday

Saturday

Sunday

Performances of dance

Will you be provisioning Performances of dance? No

Monday

Tuesday

Wednesday

Thursday

Friday

Saturday

Sunday

Similar to live music, recorded music or performances of dance

Will you be provisioning anything with a similar description to live music, recorded music or Performances of dance?

No

Monday

Tuesday

Wednesday

Thursday

Friday

Saturday

Sunday

Late Night Refreshment

Will you be provisioning any late night refreshment?

Yes

Monday

Start Time

23:00

End Time

05:00

Tuesday

Start Time

23:00

End Time

05:00

Wednesday

Start Time

23:00

End Time

05:00

Thursday

Start Time

23:00

End Time

05:00

Friday**Start Time** 23:00**End Time** 05:00**Saturday****Start Time** 23:00**End Time** 05:00**Sunday****Start Time** 23:00**End Time** 05:00

Where will the provision of late night refreshment take place? Indoors may include a tent. Both on and off premises

State any seasonal variations:For example (but not exclusively) where late night refreshment is provided on additional days during the summer months.

Non standard timings. Where the premises intends to use the premises for the provision of late night refreshment at different times from those listed above, please list: For example (but not exclusively), where you wish the activity to go on longer on a particular day e.g. Christmas Eve.

Supply of alcohol

Will you be provisioning any alcohol? Yes

Monday**Start Time** 00:00**End Time** 00:00**Tuesday****Start Time** 00:00**End Time** 00:00**Wednesday****Start Time** 00:00**End Time** 00:00**Thursday****Start Time** 00:00**End Time** 00:00**Friday****Start Time** 00:00**End Time** 00:00**Saturday**

Start Time 00:00

End Time 00:00

Sunday

Start Time 00:00

End Time 00:00

Where will the supplied alcohol be consumed? Off the premises

State any seasonal variations : For example (but not exclusively) where the supply of alcohol will occur on additional days during the summer months.

Non standard timings. Where the premises intends to use the premises for the supply of alcohol at different times from those listed above, please list: For example (but not exclusively), where you wish the activity to go on longer on a particular day e.g. Christmas Eve.

Premises Supervisor

Name DAVID HASTINGS

Address

Postcode

Date of birth

Place of birth

Personal licence number (if known)

Issuing licensing authority (if known)

Opening Hours

Monday

Start Time 00:00

End Time 00:00

Tuesday

Start Time 00:00

End Time 00:00

Wednesday

Start Time 00:00

End Time 00:00

Thursday

Start Time 00:00

End Time 00:00

Friday

Start Time 00:00

End Time 00:00

Saturday

Start Time 00:00

End Time 00:00

Sunday

Start Time 00:00

End Time 00:00

State any seasonal variations : For example (but not exclusively) where the supply of alcohol will occur on additional days during the summer months.

Non standard timings. Where you intend to use the premises to be open at different times from those listed above, please list: For example (but not exclusively), where you wish the activity to go on longer on a particular day e.g. Christmas Eve.

Adult Entertainment

Please highlight any adult entertainment or services, activities, or other entertainment or matters ancillary to the use of the premises that may give rise to concern in respect of children.

NONE.

Licensing Objectives

General - all four licensing objectives (b,c,d,e): Please list here steps you will take to promote all four licensing objectives together.

Staff shall be trained in the premises licence holder's procedures which include liquor licensing and all checkout operators shall have additional training in the sale of alcohol.
All spirits will be displayed behind the counter.
No miniature bottles of spirits of 20cl or below shall be sold from the premises. Please note this does not apply to pre packaged gift packs which may contain a spirit miniature.

The prevention of crime and disorder:

A CCTV system will be installed and maintained at the premises. Cameras will cover internal areas and the external area immediately in front of the store. The system will be capable of continuously recording and copies of such recordings shall be kept for a period of not less than 31 days and handed to the Police or authorised person upon production of a compliant 'Access Request'.
All spirits will be displayed behind the counter.

Public safety:

The premise licence holder seeks to comply with the requirements of the health and safety legislation.

The prevention of public nuisance:

N/A

The protection of children from harm:

The store will have a till prompt system for alcohol products.
When prompted, staff will adopt a Challenge 25 proof of age scheme.
Only recognised forms of photographic identification such as Passport,

Photo Driving Licence, 'Proof of Age' card, Military ID or any other form of identification agreed with the police will be accepted as proof of age. If the appropriate proof of age is not produced there will be no sale. Notices are to be prominently displayed advising customers of the Challenge 25 policy.

Right to work

Signatures

Submit & Pay

**Address for
correspondence
associated with this
application**

Postcode

Phone

**Correspondence
Email**

Confirm Email

Payment Ref

Amount to be paid: GBP 450

Order summary:

Item	Price	Total
Non-domestic rateable value of premises. -		
TOTAL		

- NOTES**
1. All dimensions to be checked on site and any discrepancy to be verified with the architect.
 2. All dimensions shall be taken from the finished floor level unless otherwise noted.
 3. Use this drawing for order quantities and specifications. When referencing dimensions, always refer to the latest CBS drawing. If the CBS drawing does not match this plan, please contact the Store Planner.
 4. For all BMS items please contact the Architect.
 5. All dimensions shall be rounded up to the nearest whole number unless otherwise indicated.

ASDA STORE PLANNING
 10000 W. 100th Street, Suite 100
 Overland Park, KS 66204
 Phone: 913.241.1000
 Fax: 913.241.1001
 Email: asda@asda.com

KEY

- FIRE EXIT
- FIRE EXTINGUISHERS
- FIRE ALARM

ASDA
 Save money. Live Better

COPTHORNE
 PROPERTY MANAGEMENT
 10000 W. 100th Street, Suite 100
 Overland Park, KS 66204
 Phone: 913.241.1000
 Fax: 913.241.1001
 Email: asda@asda.com

BMS LICENCE APPLICATION			
DATE	REVISED	DESCRIPTION	APPROVED
01/11/2017	01/11/2017	ISSUED	ASDA
02/11/2017	02/11/2017	REVISED	ASDA
03/11/2017	03/11/2017	REVISED	ASDA
04/11/2017	04/11/2017	REVISED	ASDA
05/11/2017	05/11/2017	REVISED	ASDA
06/11/2017	06/11/2017	REVISED	ASDA
07/11/2017	07/11/2017	REVISED	ASDA
08/11/2017	08/11/2017	REVISED	ASDA
09/11/2017	09/11/2017	REVISED	ASDA
10/11/2017	10/11/2017	REVISED	ASDA
11/11/2017	11/11/2017	REVISED	ASDA
12/11/2017	12/11/2017	REVISED	ASDA
01/12/2018	01/12/2018	REVISED	ASDA
02/12/2018	02/12/2018	REVISED	ASDA
03/12/2018	03/12/2018	REVISED	ASDA
04/12/2018	04/12/2018	REVISED	ASDA
05/12/2018	05/12/2018	REVISED	ASDA
06/12/2018	06/12/2018	REVISED	ASDA
07/12/2018	07/12/2018	REVISED	ASDA
08/12/2018	08/12/2018	REVISED	ASDA
09/12/2018	09/12/2018	REVISED	ASDA
10/12/2018	10/12/2018	REVISED	ASDA
11/12/2018	11/12/2018	REVISED	ASDA
12/12/2018	12/12/2018	REVISED	ASDA
01/01/2019	01/01/2019	REVISED	ASDA
02/01/2019	02/01/2019	REVISED	ASDA
03/01/2019	03/01/2019	REVISED	ASDA
04/01/2019	04/01/2019	REVISED	ASDA
05/01/2019	05/01/2019	REVISED	ASDA
06/01/2019	06/01/2019	REVISED	ASDA
07/01/2019	07/01/2019	REVISED	ASDA
08/01/2019	08/01/2019	REVISED	ASDA
09/01/2019	09/01/2019	REVISED	ASDA
10/01/2019	10/01/2019	REVISED	ASDA
11/01/2019	11/01/2019	REVISED	ASDA
12/01/2019	12/01/2019	REVISED	ASDA
01/02/2020	01/02/2020	REVISED	ASDA
02/02/2020	02/02/2020	REVISED	ASDA
03/02/2020	03/02/2020	REVISED	ASDA
04/02/2020	04/02/2020	REVISED	ASDA
05/02/2020	05/02/2020	REVISED	ASDA
06/02/2020	06/02/2020	REVISED	ASDA
07/02/2020	07/02/2020	REVISED	ASDA
08/02/2020	08/02/2020	REVISED	ASDA
09/02/2020	09/02/2020	REVISED	ASDA
10/02/2020	10/02/2020	REVISED	ASDA
11/02/2020	11/02/2020	REVISED	ASDA
12/02/2020	12/02/2020	REVISED	ASDA
01/03/2021	01/03/2021	REVISED	ASDA
02/03/2021	02/03/2021	REVISED	ASDA
03/03/2021	03/03/2021	REVISED	ASDA
04/03/2021	04/03/2021	REVISED	ASDA
05/03/2021	05/03/2021	REVISED	ASDA
06/03/2021	06/03/2021	REVISED	ASDA
07/03/2021	07/03/2021	REVISED	ASDA
08/03/2021	08/03/2021	REVISED	ASDA
09/03/2021	09/03/2021	REVISED	ASDA
10/03/2021	10/03/2021	REVISED	ASDA
11/03/2021	11/03/2021	REVISED	ASDA
12/03/2021	12/03/2021	REVISED	ASDA
01/04/2022	01/04/2022	REVISED	ASDA
02/04/2022	02/04/2022	REVISED	ASDA
03/04/2022	03/04/2022	REVISED	ASDA
04/04/2022	04/04/2022	REVISED	ASDA
05/04/2022	05/04/2022	REVISED	ASDA
06/04/2022	06/04/2022	REVISED	ASDA
07/04/2022	07/04/2022	REVISED	ASDA
08/04/2022	08/04/2022	REVISED	ASDA
09/04/2022	09/04/2022	REVISED	ASDA
10/04/2022	10/04/2022	REVISED	ASDA
11/04/2022	11/04/2022	REVISED	ASDA
12/04/2022	12/04/2022	REVISED	ASDA
01/05/2023	01/05/2023	REVISED	ASDA
02/05/2023	02/05/2023	REVISED	ASDA
03/05/2023	03/05/2023	REVISED	ASDA
04/05/2023	04/05/2023	REVISED	ASDA
05/05/2023	05/05/2023	REVISED	ASDA
06/05/2023	06/05/2023	REVISED	ASDA
07/05/2023	07/05/2023	REVISED	ASDA
08/05/2023	08/05/2023	REVISED	ASDA
09/05/2023	09/05/2023	REVISED	ASDA
10/05/2023	10/05/2023	REVISED	ASDA
11/05/2023	11/05/2023	REVISED	ASDA
12/05/2023	12/05/2023	REVISED	ASDA
01/06/2024	01/06/2024	REVISED	ASDA
02/06/2024	02/06/2024	REVISED	ASDA
03/06/2024	03/06/2024	REVISED	ASDA
04/06/2024	04/06/2024	REVISED	ASDA
05/06/2024	05/06/2024	REVISED	ASDA
06/06/2024	06/06/2024	REVISED	ASDA
07/06/2024	07/06/2024	REVISED	ASDA
08/06/2024	08/06/2024	REVISED	ASDA
09/06/2024	09/06/2024	REVISED	ASDA
10/06/2024	10/06/2024	REVISED	ASDA
11/06/2024	11/06/2024	REVISED	ASDA
12/06/2024	12/06/2024	REVISED	ASDA
01/07/2025	01/07/2025	REVISED	ASDA
02/07/2025	02/07/2025	REVISED	ASDA
03/07/2025	03/07/2025	REVISED	ASDA
04/07/2025	04/07/2025	REVISED	ASDA
05/07/2025	05/07/2025	REVISED	ASDA
06/07/2025	06/07/2025	REVISED	ASDA
07/07/2025	07/07/2025	REVISED	ASDA
08/07/2025	08/07/2025	REVISED	ASDA
09/07/2025	09/07/2025	REVISED	ASDA
10/07/2025	10/07/2025	REVISED	ASDA
11/07/2025	11/07/2025	REVISED	ASDA
12/07/2025	12/07/2025	REVISED	ASDA
01/08/2026	01/08/2026	REVISED	ASDA
02/08/2026	02/08/2026	REVISED	ASDA
03/08/2026	03/08/2026	REVISED	ASDA
04/08/2026	04/08/2026	REVISED	ASDA
05/08/2026	05/08/2026	REVISED	ASDA
06/08/2026	06/08/2026	REVISED	ASDA
07/08/2026	07/08/2026	REVISED	ASDA
08/08/2026	08/08/2026	REVISED	ASDA
09/08/2026	09/08/2026	REVISED	ASDA
10/08/2026	10/08/2026	REVISED	ASDA
11/08/2026	11/08/2026	REVISED	ASDA
12/08/2026	12/08/2026	REVISED	ASDA
01/09/2027	01/09/2027	REVISED	ASDA
02/09/2027	02/09/2027	REVISED	ASDA
03/09/2027	03/09/2027	REVISED	ASDA
04/09/2027	04/09/2027	REVISED	ASDA
05/09/2027	05/09/2027	REVISED	ASDA
06/09/2027	06/09/2027	REVISED	ASDA
07/09/2027	07/09/2027	REVISED	ASDA
08/09/2027	08/09/2027	REVISED	ASDA
09/09/2027	09/09/2027	REVISED	ASDA
10/09/2027	10/09/2027	REVISED	ASDA
11/09/2027	11/09/2027	REVISED	ASDA
12/09/2027	12/09/2027	REVISED	ASDA
01/10/2028	01/10/2028	REVISED	ASDA
02/10/2028	02/10/2028	REVISED	ASDA
03/10/2028	03/10/2028	REVISED	ASDA
04/10/2028	04/10/2028	REVISED	ASDA
05/10/2028	05/10/2028	REVISED	ASDA
06/10/2028	06/10/2028	REVISED	ASDA
07/10/2028	07/10/2028	REVISED	ASDA
08/10/2028	08/10/2028	REVISED	ASDA
09/10/2028	09/10/2028	REVISED	ASDA
10/10/2028	10/10/2028	REVISED	ASDA
11/10/2028	11/10/2028	REVISED	ASDA
12/10/2028	12/10/2028	REVISED	ASDA
01/11/2029	01/11/2029	REVISED	ASDA
02/11/2029	02/11/2029	REVISED	ASDA
03/11/2029	03/11/2029	REVISED	ASDA
04/11/2029	04/11/2029	REVISED	ASDA
05/11/2029	05/11/2029	REVISED	ASDA
06/11/2029	06/11/2029	REVISED	ASDA
07/11/2029	07/11/2029	REVISED	ASDA
08/11/2029	08/11/2029	REVISED	ASDA
09/11/2029	09/11/2029	REVISED	ASDA
10/11/2029	10/11/2029	REVISED	ASDA
11/11/2029	11/11/2029	REVISED	ASDA
12/11/2029	12/11/2029	REVISED	ASDA
01/12/2030	01/12/2030	REVISED	ASDA
02/12/2030	02/12/2030	REVISED	ASDA
03/12/2030	03/12/2030	REVISED	ASDA
04/12/2030	04/12/2030	REVISED	ASDA
05/12/2030	05/12/2030	REVISED	ASDA
06/12/2030	06/12/2030	REVISED	ASDA
07/12/2030	07/12/2030	REVISED	ASDA
08/12/2030	08/12/2030	REVISED	ASDA
09/12/2030	09/12/2030	REVISED	ASDA
10/12/2030	10/12/2030	REVISED	ASDA
11/12/2030	11/12/2030	REVISED	ASDA
12/12/2030	12/12/2030	REVISED	ASDA

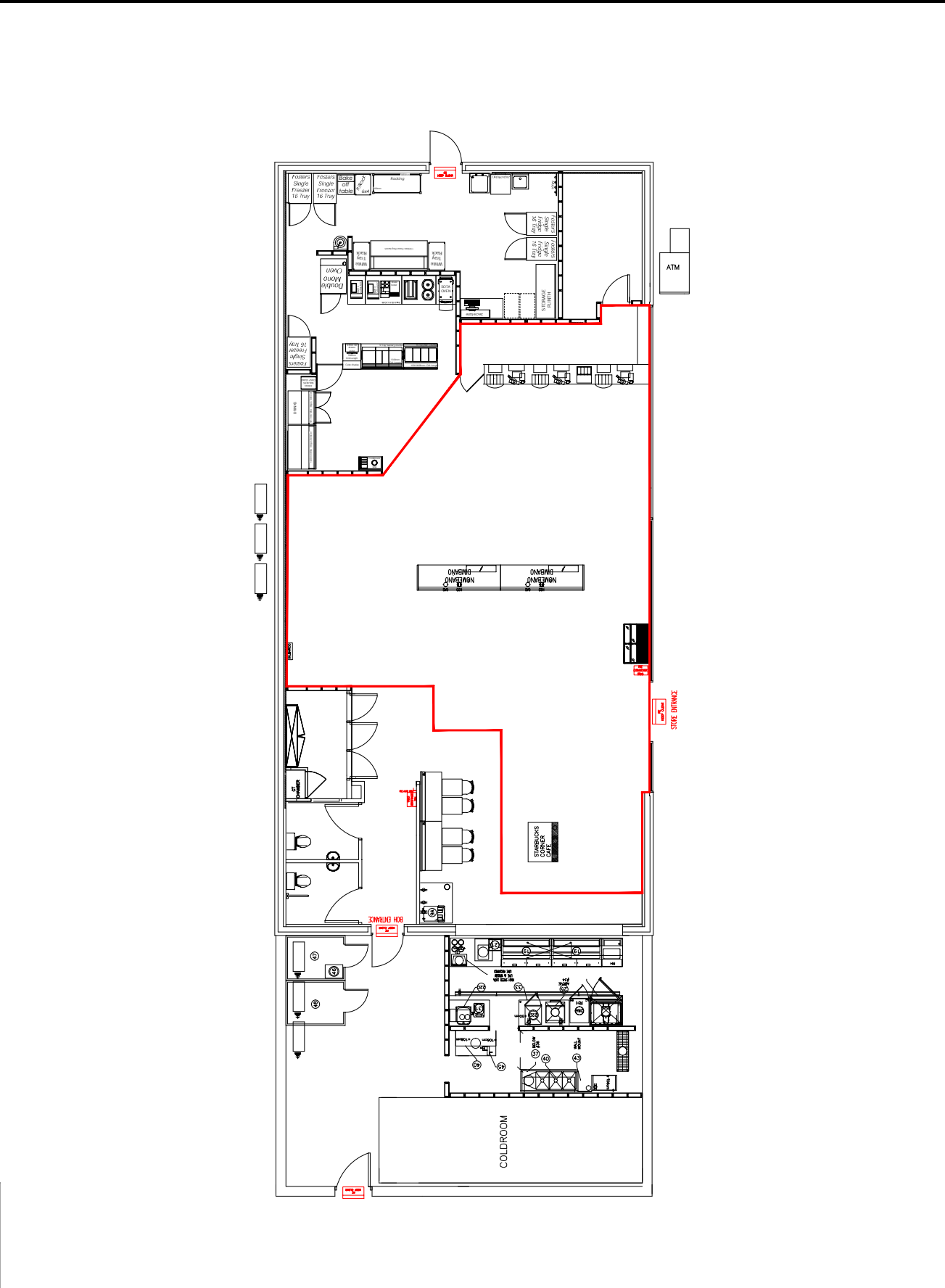

Feet	6'	66'	7'	76"	8'	86"	9	96"	10'	106"	11'	12'	13'	14'	15'	16'
mm	1830	2000	2100	2300	2400	2600	2700	2900	3000	3200	3300	3700	4000	4200	4600	4800

SP-GE-6247 | **1**
GROUND FLOOR
BMS LICENCE APPLICATION
 Scale: 1:100